

JEFFERSON[®] MARQUESSA[®]

STANDARD DECKHOUSE • EXTENDED DECKHOUSE • EXTENDED DECKHOUSE WITH COCKPIT



JEFFERSON[®] YACHTS

JEFFERSON® MARQUESSA®

STANDARD DECKHOUSE • EXTENDED DECKHOUSE • EXTENDED DECKHOUSE WITH COCKPIT

Specifications

JEFFERSON® 52 MARQUESSA®

L.O.A.	52'4"	Water Capacity	200 Gal.
Beam	16'0"	Fuel Capacity	700 Gal.
Draft	4'0"	Approx. Weight.....	55,800 Lb.
Height above waterline to top of optional radar arch	19'6"	Engine	Twin 550 BHP Detroit Diesels

JEFFERSON® 56 MARQUESSA®

L.O.A.	56'4"	Water Capacity	200 Gal.
Beam	16'0"	Fuel Capacity	700 Gal.
Draft	4'0"	Cockpit	
Height above waterline to top of optional radar arch	19'6"	Approx. Weight.....	57,500 Lb. EDH
Engine.....	Twin 550 BHP Detroit Diesels*	Approx. Weight.....	59,000 Lb.

*Optional power available to twin 735 BHP (EDH only)

HULL, DECK AND SUPERSTRUCTURE

High-gloss ISO gelcoat with contrasting accent & boot top stripes
Hand laid-up fiberglass reinforced polyester hull and flying bridge
FRP non-skid surface on exterior decks

ENGINE AND MECHANICAL

Dual lever clutch and throttle controls
Twin diesel freshwater-cooled engines with exhaust silencers
Halon fire extinguisher system
Four-blade propellers
Freshwater outlets in engine rooms
Fuel filters on engines and genset water-separating RACOR®
Fuel primer pump on main engines
Aluminum fuel tanks
15KW diesel generator with sound cover
Hydraulic steering
Lead-lined foam insulation, machinery spaces
Dual steering stations, each with full controls and instrumentation
Reduction gear transmissions
Seacocks with strainers for engines, genset and air conditioning
Stainless steel shafts, 2-1/2" diameter
Adjustable hydraulic trim tabs
Ventilation ducts and electric blowers in machinery spaces

DECK FITTING AND HULL HARDWARE

Bowstaff with pennant
Chain locker in forepeak
Chocks, bow and stern
Stainless steel cleats, bow, stern and springline
FRP bow pulpit with anchor fairlead
Screens on opening windows and port lights
Stainless steel handrails with lifeline
Removable stern staff with socket
Swim platform with boarding steps and ladder to aft deck
Tinted safety glass side windows
Wet sink and bar cabinet (extended deckhouse models only)
Wet sink on flying bridge
Tinted acrylic windscreen with stainless steel frame, bridge

JEFFERSON YACHTS, INC.

P.O. Box 790
106 W. Court Avenue
Jeffersonville, IN 47131
812/282-8111

JY1289MQ



ELECTRICAL SYSTEM

Marine air conditioning with reverse cycle heating
Automatic 50 amp battery charger
Anti-corrosion bonding system
AC and DC electric system control panels with circuit breakers
Electric dual-trumpet air horns
120V AC and 12V DC interior lighting
Galley microwave with exhaust fan**
Navigation lighting
19.6 cu. ft. frost-free refrigerator/freezer with icemaker**
Dual 240V AC shore power inlets
Four-burner electric stove with oven**
Electric windshield wipers

SANITARY AND PUMP SYSTEM

Electric automatic bilge pumps (two)
Manual emergency bilge pump
Holding tank with macerator pump
Seawater washdown spigot on fore deck
Electric automatic sump pump
Marine electric toilets with household-size bowls, plumbed to holding tank with Y-valve
Transom shower with pressure hot and cold water
Electric water heater

MISCELLANEOUS

Camphorwood lining in hanging lockers
Cultured marble lavatory counter tops and basins
Vinyl-covered bridge seat bench and fore deck trunk cushions
Six-inch foam cushions on all berths
Saloon and stateroom draperies
Entertainment center cabinet, extended deckhouse model saloon
Furniture quality teak interior cabinetry and joinery
Wing doors, side deck to aft deck (standard deckhouse models only)

**Provided by Jefferson Yachts & installed by dealer.

Specifications are subject to change without notice.

JEFFERSON MARQUESSA®

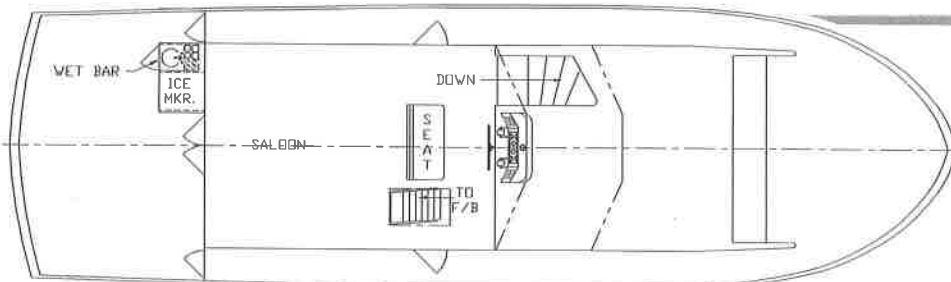

52 Deckhouse Saloon Deck Plan

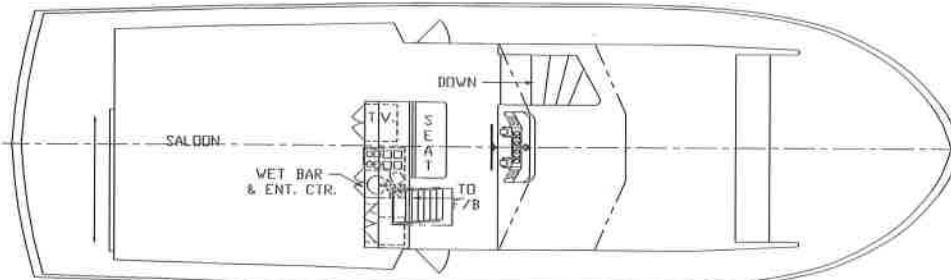

52 Extended Deckhouse Saloon Deck Plan

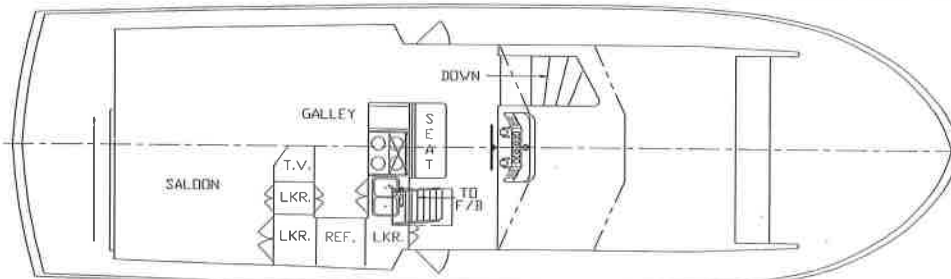

52 EDH Saloon Deck Plan, Galley Up

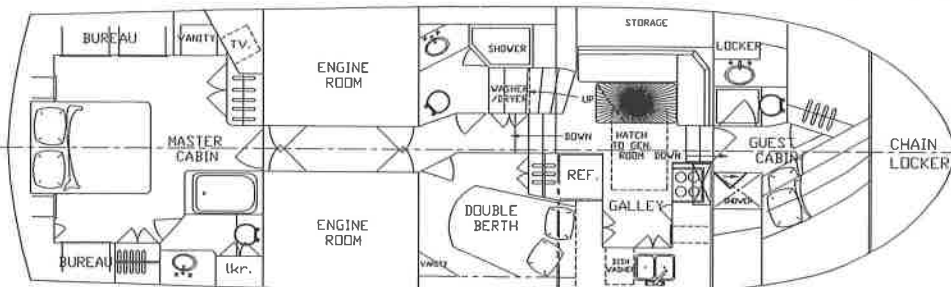

52 Cabin Deck Plan A

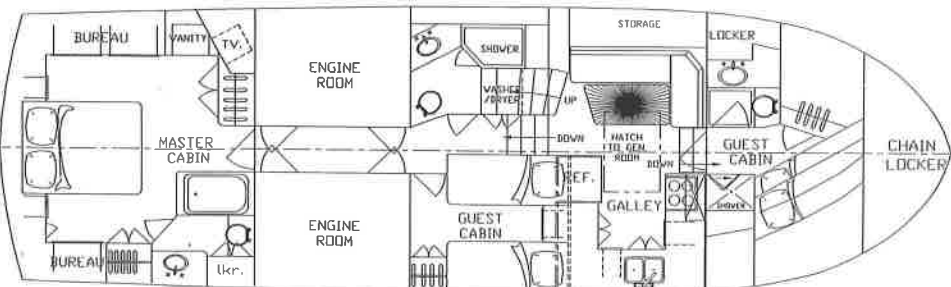

52 Cabin Deck Plan B

The Marquessa is Jefferson Yachts' grande dame: regal, elegant, in command of the seas. So imposing is this magnificent motor yacht that only the most self-assured yachtsmen approach her helm.

The Marquessa was designed to be accommodating on longer cruises—a veritable home at sea. Available in standard deckhouse, extended deckhouse and extended deckhouse with cockpit models, the yacht offers at least three, and up to four staterooms, depending on the floor plan selected. Because of Jefferson Yachts' characteristic versatility, an additional double berth may be converted from dinette or lounge in each plan.

The beauty of this boat begins with her striking exterior. The streamlined figure, more than 52 or 56 feet long, and 16 feet wide, belies her rugged preparedness for heavy seas. There's Jefferson Yachts' exclusive professionally engineered, tank-tested hull design for maximum performance at lower horsepower ratios. Solidly constructed of hand laid-up, heavily-reinforced fiberglass, this hull was built to compliment the powerful thrust of the twin 550 BHP Johnson & Towers 6V92TA Detroit Diesel engines. High-gloss gel covers and protects the exterior, with a contrasting boot top stripe adding to the craft's sleekness.

On the deckhouse model, there's a spacious sundeck for relaxing in comfort, with room for a wet bar, if you choose. Up on the flying bridge is a commanding view, a wet sink, and more room to entertain! The full controls and instrumentation of the upper helm station are duplicated in the lower helm, forward in the saloon.

In the extended deckhouse model, you'll find one of the grandest saloons ever designed, lined and trimmed with handsome, hand-rubbed teakwood ready for individual appointment. You may choose to have your galley here on the saloon deck, allowing for a fourth stateroom

JEFFERSON® MARQUESSA®

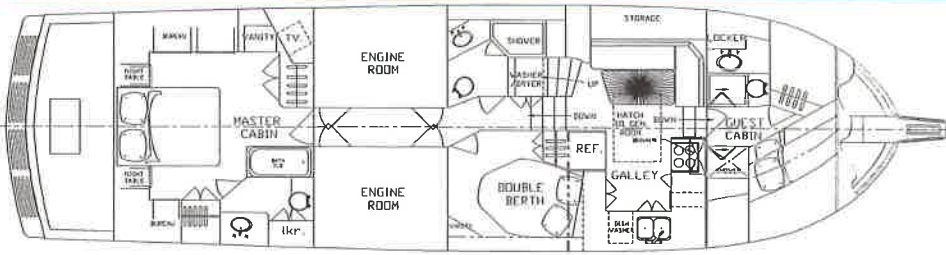

56 Cockpit Plan A

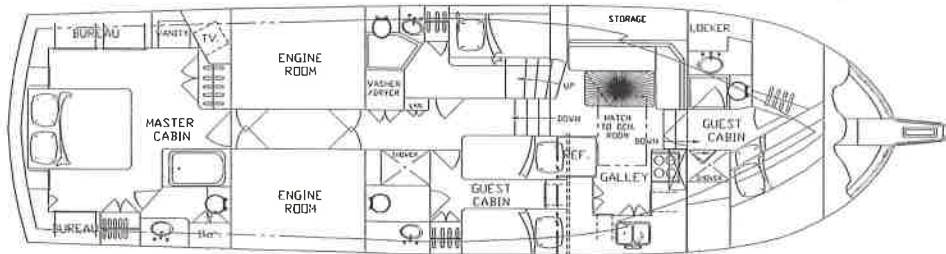

56 Cabin Deck Plan A

on the cabin deck, or you may have a galley and dinette below.

Even-though the Marquessa is a production yacht, several floor plan choices allow owners considerable personalization.

Aft, on the cabin deck, is the huge master stateroom, featuring queen berth, two bureaus, double-size hanging lockers, and master head

with tub, shower and vanity. Forward of this stateroom are the lead-lined foam-insulated engine rooms. The rest of the cabin floor is up to you.

The mid-ship guest cabin may have two single berths or one double, with a head and separate shower opposite. Continuing forward can be the galley and dinette area—

or another guest cabin, with lounge area. Yet another guest cabin is situated in the bow, with upper and lower berths.

For a complete explanation of the available options, see the deck plan drawings presented elsewhere in this flyer.

The majesty of the Marquessa extends to her long list of standard equipment, including Aqua Air® Marine Air Conditioning with zone control and reverse cycle heating, a 15KW Westerbeke diesel generator with sound cover, full-size household appliances, cultured marble lavatory counter tops and bowls, camphor-wood-lined hanging lockers, teakwood cabinetry, walls, parquet floors and joinery, a Halon fire extinguisher system, circuit-breaker protected AC and DC electrical systems, and much, much more.

56 Extended Deckhouse Marquessa with Cockpit

